

NORTHEAST 136TH STREET



CREATE A PLACE WHERE TRADITION CAN ENDURE

HIGHLIGHTS

Attached Townhouse

1,902 square feet

2 Bedrooms

2½ Bathrooms

Ground floor flex space

Attached garage

Roof deck terrace



CREATE A PLACE WHERE TRADITION CAN ENDURE with Northeast 136th Street, a three story townhouse intended to be built in multiples as part of an attached block. This plan features an open living, dining and kitchen area with an island and bar height dining. A bonus room with a private entry and optional bath provides flex space for additional bedroom, rental unit or home office. A charming roof deck terrace detailed with a trellis creates the perfect place for outdoor entertaining.

SUMMARY

Bedrooms: 2
Bathrooms: 2½
Floors: 3
Foundation: Slab

DIMENSIONS

Width: 15'-11"
Depth: 60'
Height: 42'-3" to highest ridge
Ceiling Height: 10' - main floor
10' - upper floors

AREA

Conditioned: 1,902 sq. ft.
Unconditioned: 1,339 sq. ft.
TOTAL: 3,241 sq. ft.

RE-USE FEE/RESTRICTIONS

Construction Documents: Schedule 'G'
Interiors Package: Schedule '4'
No re-use within 100 miles of Atlanta, Georgia

(Minimum 5 units; fewer units require alternate structural considerations)



SIDE ELEVATION



REAR ELEVATION

FLOORPLAN

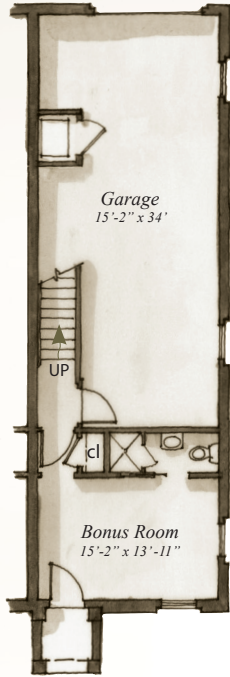

STREET LEVEL
240 S.F.

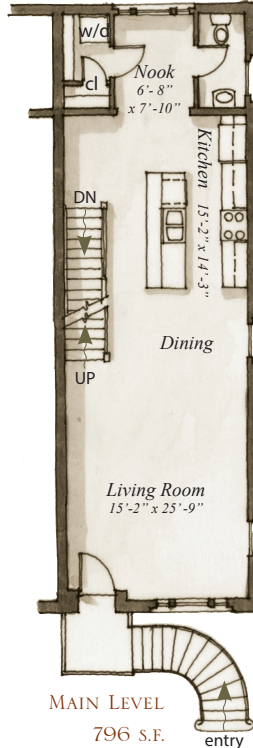

MAIN LEVEL
796 S.F.

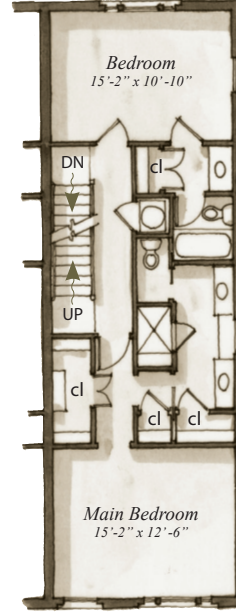

UPPER LEVEL
796 S.F.



ROOF LEVEL
70 S.F.
(ADDITIONAL
726 S.F. ROOF DECK)

ARCHITECTURAL DETAILS

EXTERIOR:

- Brick exterior accented by curved stair with metal railing
- Authentic brick details, such as brackets and cornice, add visual interest
- Generously proportioned windows on front and rear façade provide for ample natural light and views
- Recessed front door with folded shutter detail provides authentic character to the entrance
- Secondary entry into street level bonus room is located under main staircase

INTERIOR:

- Well-detailed and proportioned trim details
- Shared light via transoms over doors and between rooms
- Kitchen cabinetry with integrated appliances
- Bank of windows at roof deck allows natural light to fill stairwell and upper level

Plans are available on a limited basis. All dimensions are approximate.

NORTHEAST 136TH STREET

PLAN PRICING:

SCHEDULE 'G' CONSTRUCTION DOCUMENTS RE-USE FEE (INCLUDES 3 PLAN SETS)

SCHEDULE '4' INTERIORS PACKAGE RE-USE FEE

\$50 PER ADDITIONAL PLAN SET

\$40 GROUND SHIPPING/HANDLING

OUR
TOWN
PLANS