

57 HATTIESBURG DRIVE

OUR
TOWN
P L A N S

CREATE A PLACE WHERE TRADITION CAN ENDURE

HIGHLIGHTS

4,399 square feet

2 Bedrooms

2½ Bathrooms

Built-in bookcases

Library with fireplace

**Optional Attic Suite
(additional 1,210 s.f.)**



CREATE A PLACE WHERE TRADITION CAN ENDURE with 57 Hattiesburg Drive, a richly detailed Greek Revival home. This grand home is perfectly suited for indoor and outdoor entertaining with its spacious interior and abundant porches. Reflecting quality and permanence, this home makes a stately addition to any neighborhood streetscape.

SUMMARY

Bedrooms: 2 (plus 1 optional)
Bathrooms: 2½ (plus 1 optional)
Floors: 2½
Foundation: Crawl-space-wall

DIMENSIONS

Width: 62'-9"
Depth: 76'-10"
Height: 52'-5" to highest ridge
Ceiling Height: 10'-11" - main floor
10'-1" - upper floor
9' - attic floor

AREA

Conditioned: 4,399 sq. ft.
Unconditioned: 1,269 sq. ft.
TOTAL: 5,668 sq. ft.

RE-USE FEE/RESTRICTIONS

Construction Documents: Schedule 'L'
Interiors Package: Schedule '10'



SIDE ELEVATION



REAR PERSPECTIVE

FLOORPLAN



OPTIONAL
ATTIC FLOOR
1210 S.F.

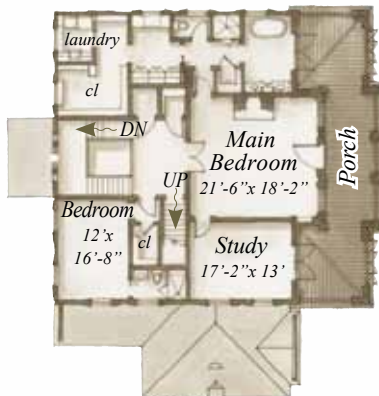

UPPER FLOOR
2021 S.F.



MAIN FLOOR
2378 S.F.

Plans are available on a limited basis. All dimensions are approximate.

ARCHITECTURAL
DETAILS

EXTERIOR:

- Greek Revival home with stucco foundation, Greek Doric columns, iron railings, large cornices and gabled roof
- Standing seam metal roof in keeping with vernacular
- Oversized windows with 6-over-6 lite pattern and operable shutters
- Well-proportioned and detailed front door with side lights and transoms
- Full-width covered porch, accessed by great room, kitchen, and library offers outdoor living with operable shutters for privacy

INTERIOR:

- Well-proportioned and refined architectural trim details with varied profiles
- Extensive use of transoms over doors and cased openings for shared light
- Masonry fireplaces with wood surrounds in great room, library and keeping room
- Kitchen with prep island, abundance of storage space and integrated appliances
- Built-in cabinetry, bookcases and storage throughout house
- Cupola floods optional attic floor with natural light

57 HATTIESBURG DRIVE

PLAN PRICING:

SCHEDULE 'L' RE-USE FEE (INCLUDES 3 PLAN SETS)\$1,100

SCHEDULE '10' INTERIORS PACKAGE RE-USE FEE
\$50 PER ADDITIONAL PLAN SET

\$40 GROUND SHIPPING/HANDLING

